



County of Bruce
Planning & Development Department
30 Park Street, Box 848
Walkerton, ON N0G 2V0
brucecounty.on.ca
226-909-5515

September 11, 2020

File Number: B-2020-072

Consent Application Notice

A change is proposed in your neighbourhood: The purpose of the application is to sever a 1188.72 sq. m parcel of land containing a driveway from Concession 1 NDR South Part Lot 39 and add it to an adjacent parcel at 3320 Highway 9. The related Zoning file is Z-2020-053.



3320 Highway 9 – CON 1 NDR PT LOT 39; and
CON 1 NDR S PT LOT 39 (Greenock), Municipality of Brockton
Roll Numbers 410431000120300 and 410431000120400

Learn more

You can view more information about the applications at <https://brucecounty.on.ca/living/land-use>. Once our offices re-open, information about the application will be available in person at the County of Bruce Planning Office noted above, between 8:30 a.m. and 4:30 p.m. (Monday to Friday).

COVID-19 Notice: Bruce County planning offices are closed to the public until further notice. Our staff would be pleased to connect with you by email or phone.

Have your say

Comments and opinions submitted on these matters, including the originator's name and address, become part of the public record, may be viewed by the general public and may be published in a Planning Report and Council Agenda.

1. Please contact us if you have any questions, concerns or objections about the application. Comments received after October 2, 2020 may not be included in the Planning report but will be considered and included in the official record on file.

The Planner on the file is: Julie Steeper

Stay in the loop

If you wish to be notified of the decision of the County of Bruce Land Division Committee on the proposed consent, you must make a written request to the County of Bruce at the mailing address noted at the top of this Notice or by emailing bcplwa@brucecounty.on.ca.

Know your rights

Section 53(19) of the [Planning Act](#) outlines rights of appeal for Consent applications.

If a person or public body that files an appeal of a decision of the County of Bruce in respect of the proposed consent does not make written submissions to the County of Bruce before it gives, or refuses to give, a provisional Consent, the Local Planning Appeal Tribunal may dismiss the appeal.

For more information please visit the Local Planning Appeal Tribunal website at <https://elto.gov.on.ca/tribunals/lpat/about-lpat/>

COVID-19 Notice: Bruce County planning offices are closed to the public until further notice. Our staff would be pleased to connect with you by email or phone.

Site plan

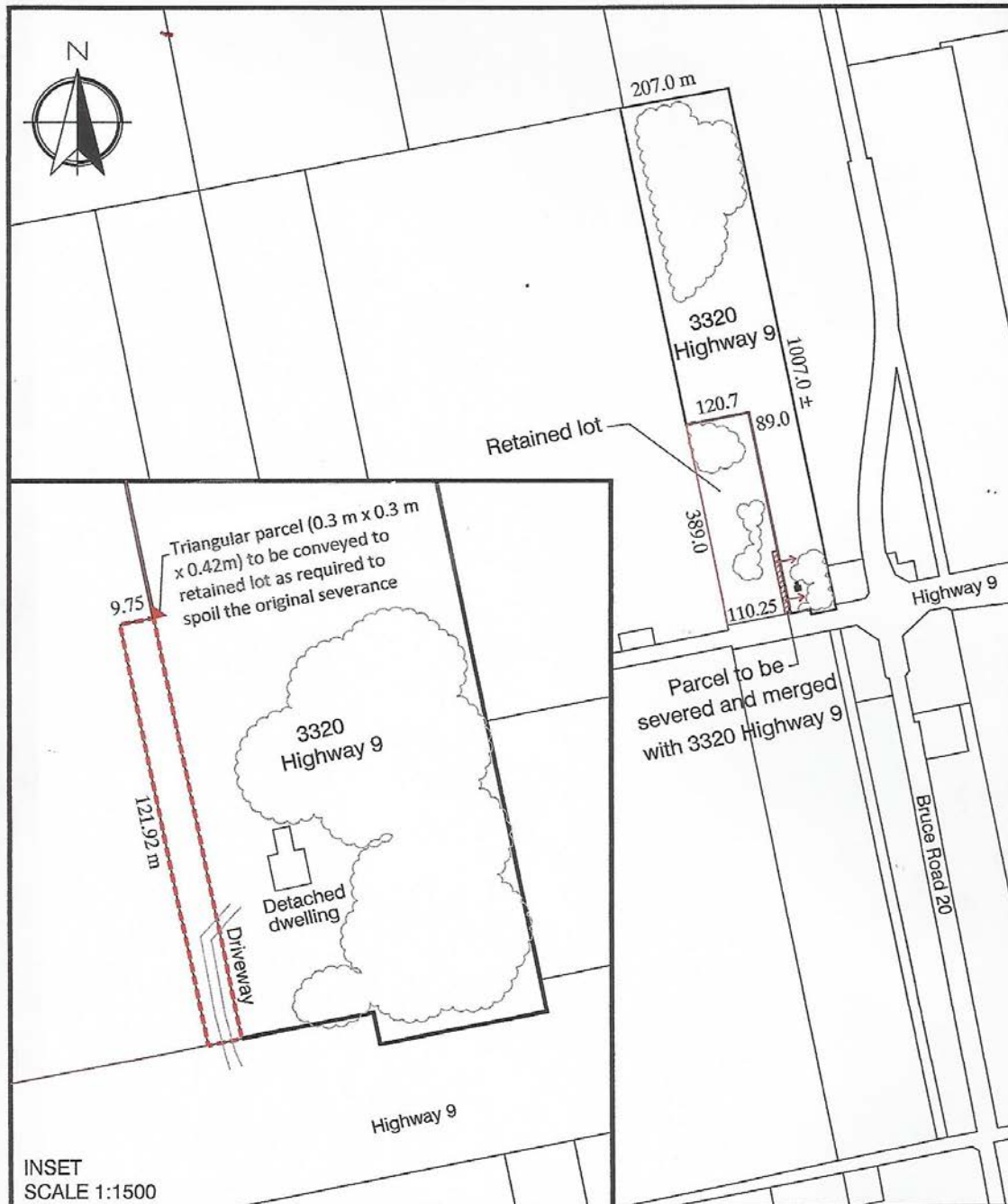

Lot Line Adjustment
3320 Provincial Highway 9
Municipality of Brockton

RD RON DAVIDSON
LAND USE PLANNING CONSULTANT INC
OWEN SOUND, ONTARIO

SCALE 1:10 000

COVID-19 Notice: Bruce County planning offices are closed to the public until further notice. Our staff would be pleased to connect with you by email or phone.