

Residential Hospice Care in Grey-Bruce

- When asked, most people would prefer to die at home. Sometimes due to a combination of pain, symptoms and home circumstances this is not able to happen. Hospice care helps people to die in comfort and dignity:
 - Expertise in end-of-life pain and symptom management
 - Focus on patient and family care
- Hospice care is provided at no charge to it's residents and families - it is completely free
- Hospice care benefits the overall health care system:
 - Reduced Emergency room visits and hospital admissions
 - Improved bed utilization and reduced in-hospital acute care stays by palliative patients
 - Hospice care costs about \$600 per day, a hospital stay is about \$1200 per day
- Our needs are great and becoming greater:
 - High number of seniors in Grey-Bruce who represent 70% of all hospice admissions to-date
 - Our average age is among the highest in Canada

About Residential Hospice Grey Bruce Inc.(RHGB)

A registered charity established in 2012. We own and operate Chapman House in Owen Sound. The Ministry of Health have approved funding for us to operate an additional 6 beds in south Bruce County.

Residential hospices are only funded by the provincial government for a portion of their operation. Funding can only be applied towards the salaries of Nurses and Personal Support Workers

All other aspects of our operation, including patient meals, medical supplies, utilities, equipment and other comforts are supported entirely by community donation

Our desire is to establish a standalone facility similar in design, style and services to Chapman House in South Bruce meeting the Ministry's funding requirements and importantly enabling hospice access within a 50 minute drive for most Grey Bruce residents

Our Request of Brockton Municipality

Our satellite Hospice is going to be built solely through donations from our community. We need to secure land to locate our building in order to begin the process

Requested:

1. Donation of a municipally owned land parcel located in Eastridge Park (noted as “A” on site map on next slide).
2. Agree to provide services and road construction coordinated with a targeted opening of May 2024
3. Waive fees and costs for:
 - Site Plan Application for both planning and engineering
 - Building Permit and Servicing fees
 - Any other Site Plan Approval costs

Proposed location- Noted as "A"

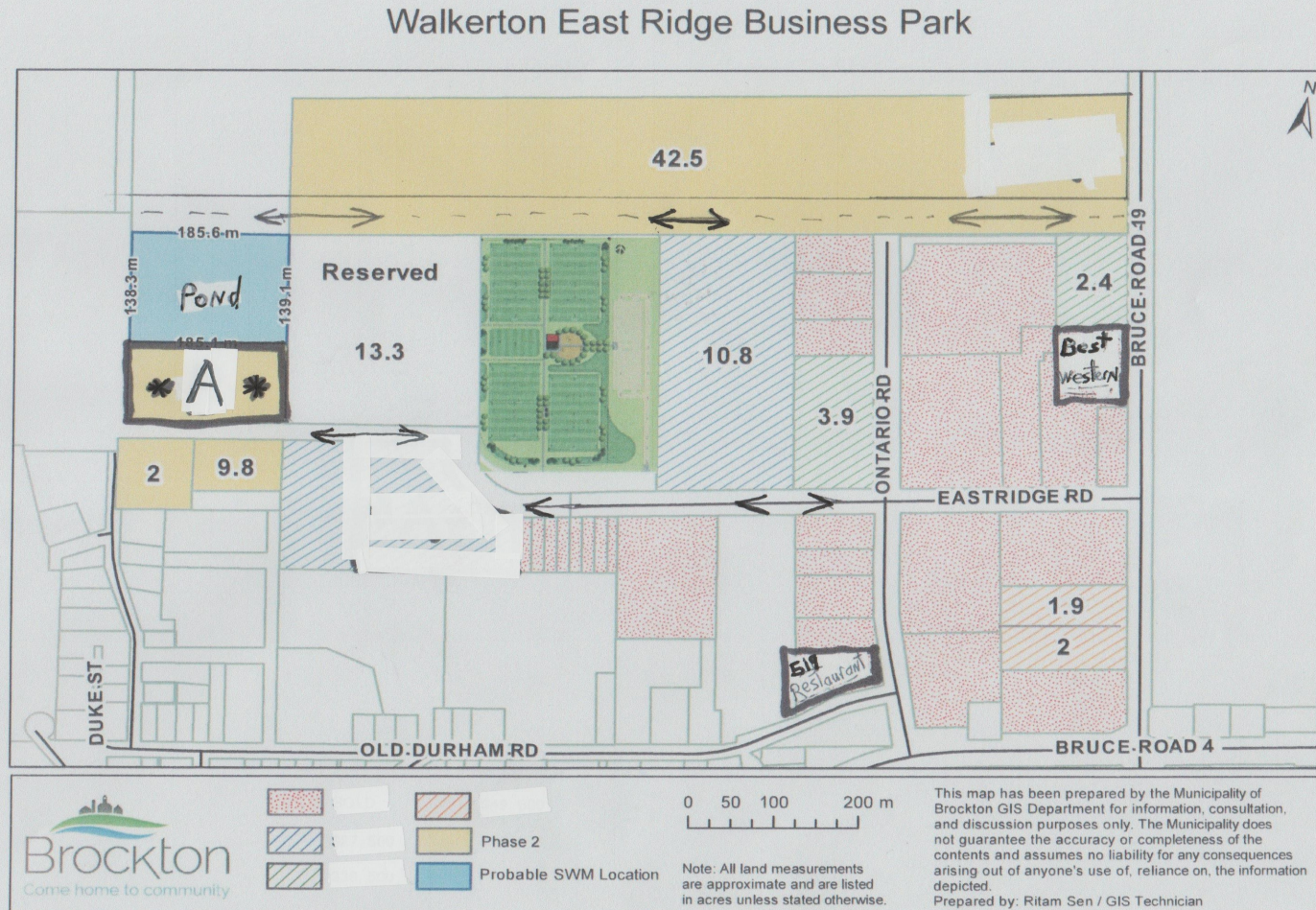

Why should Brockton support us?

- We are an essential service with a growing need
- Creates 7 to 10 new healthcare jobs
- Helps with attracting and retaining physicians and specialists
- No cash outlay
- Enables municipality to demonstrate a leadership role in Grey and Bruce counties recognizing the demographic reality
- Could act as a catalyst for development of other land within Eastridge Park